



EduHeal Foundation

EDUHEAL FOUNDATION CONDUCTS 8 OLYMPIADS ANNUALLY REACHING OUT TO 3,500 + SCHOOLS
• 5 LAKH + STUDENTS • 50,000 TEACHERS AND HAVING 500 RESOURCE PERSONS
IN ENGLISH / MATHS / SCIENCE / BIOTECH / COMPUTER / G.K. / ARTS / CRICKET / FINANCE & 300 REGIONAL COORDINATORS.

WEBSITE : WWW.EDUHEALFOUNDATION.ORG • E-MAIL : INFO@EDUHEALFOUNDATION.ORG

ICO INTERNATIONAL CYBER OLYMPIAD	NISO NATIONAL INTERACTIVE SCIENCE OLYMPIAD	NIMO NATIONAL INTERACTIVE MATH OLYMPIAD	NBTO NATIONAL BIOTECHNOLOGY OLYMPIAD	IEO INTERNATIONAL ENGLISH OLYMPIAD	IGO INTERNATIONAL G.K. OLYMPIAD	BIFO BSE INTERNATIONAL FINANCE OLYMPIAD	NIPO NATIONAL IIT-PMT OLYMPIAD
---	---	--	--	---	--	--	---

Level - 1 : All Level-1 successful* participants will get certificate, aptitude report and online subscription, and school toppers will be eligible for school hero medals.

Level - 2 : School toppers* will be selected for level-2-National level - online computer based interactive test held at exam centres all over India. Besides selection for level-3, winner will get merit certificate, medals, educational CDs, laptop, scholarship and other prizes. There is no level 2 in Art, Cricket, Cyber, NIPO and Biotech.

Level - 3 : Toppers will qualify# for level 3-International level-where you will compete with students globally. Get selected for EHF's International Olympiad training camp. Only Indian organization giving students exposure to global competitions. Represent India & win laurels. Guidance by top scientists. Prizes ranges from cash (millions of \$), gadgets, foreign trips, publicity, fame, scholarships, Internships, conference participation and more.

* # See prospectus/website for details

1. You are allowed additional 10 minutes to fill the required details in the **RESPONSE SHEET (OMR)**.
2. The question paper is made as per syllabus guidelines & pattern given in the information Booklet. The Question Paper for Classes 1 to 6 contains 25 Questions each to be answered in 40 minutes. The Question paper for classes 7 to 12 contains 50 Questions each to be answered in 60 minutes. All questions are compulsory. Further instructions are given in the instruction letter to the teacher.
3. Use the response sheet to mark your responses by darkening the required circle. The response sheet has to be returned to the foundation, duly filled in. **THE STUDENT CAN RETAIN THE QUESTION PAPER.**

EHF
INTERNATIONAL
CYBER
OLYMPIAD

ICO

7
Class

A1
Paper
Code

LEVEL - 1

MENTAL ABILITY

1. If 'P' means '×', 'Q' means '÷', 'T' means 'of' and 'V' means '+', then what will be the value of
 $85 Q 17 P 3 V 1 T 4 = ?$
(1) 62 (2) 31
(3) 19 (4) None of these
2. Early morning after sunrise, Anil was standing in front of his house in such a way that his shadow was falling exactly behind him. He starts walking straight and walks 5 metres, then turns to his left and walks 3 metres and again turning to his left walks 2 metres. Now in which direction is he from his starting point?
(1) South (2) West
(3) North-East (4) None of these

Directions (3-4): What value should come in place of question mark (?) in the following questions?

3. $52 \times 87 - 500 = ?$
(1) 4000 (2) 4124
(3) 4024 (4) None of these
4. $2.56 \times (13) 2 = ?$
(1) 270.4 (2) 432.64
(3) 208.00 (4) None of these
5. Choose the missing term out of the given alternatives.
Y, W, U, S, Q, ?, ?
(1) N, J (2) M, L
(3) O, M (4) None of these
6. Choose the word which is least like the other words in the group:
(1) Tiger (2) Lion
(3) Fox (4) None of these

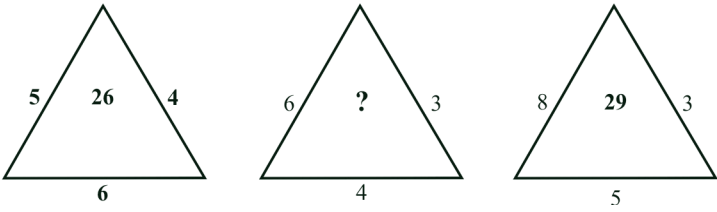
7. In a row of trees, one tree is fifth from either end of the row. How many trees are there in the row?
 (1) 8 (2) 9
 (3) 10 (4) None of these
8. Find the missing number:
- 
- (1) 32 (2) 22
 (3) 18 (4) None of these
9. 7 numbers have an average of 13 and the average of other 13 numbers is 7. What would be the average of these 20 numbers?
 (1) 9.1 (2) 3.9
 (3) 6.8 (4) None of these
10. Write the number of the pair, the words of which do not have the same type of meaning as others.
 (1) Shade and colour (2) Drink and Sip
 (3) Short and Tall (4) None of these

COMPUTERS

11. Changing the style, colour and size of the text is known as —
 (1) Text editing
 (2) Text formatting
 (3) Text typing
 (4) None of these
12. A smallest unit of information which computer can process.
 (1) Kilobyte (2) Byte
 (3) BIT (4) None of these
13. Through which device the main components of the computer communicate with each other?
 (1) Keyboard (2) System Bus
 (3) Monitor (4) None of these
14. Basic is _____ language.
 (1) a procedural (2) an object oriented
 (3) both 1 & 2 (4) none of these

15. Which of the keys is used to move the cursor to the start of a line?
 (1) Home (2) Page up
 (3) Ctrl Home (4) None of these
16. The window which shows icons for things like the mouse, sound and display is _____.
 (1) My computer (2) Explorer
 (3) Control Panel (4) None of these
17. On the Task bar the time is shown in the _____.
 (1) Start Menu
 (2) Notification area or Tray
 (3) Desktop
 (4) None of these
18. Which part of the computer helps to store information?
 (1) Disk drive (2) Monitor
 (3) Printer (4) None of these
19. IT stands for:
 (1) Information Technology
 (2) Integrated Technology
 (3) Intelligent Techonology
 (4) None of these
20. A(n) _____ contains commands that can be selected.
 (1) pointer (2) menu
 (3) icon (4) none of these
21. An error is also known as:
 (1) bug (2) debug
 (3) cursor (4) none of these
22. Any data or instruction entered into the memory of a computer is considered as:
 (1) storage (2) output
 (3) input (4) none of these
23. A series of instructions that tells a computer what to do it is called a:
 (1) command (2) processor
 (3) program (4) none of these
24. What are the two types of output devices?
 (1) Monitor and printer
 (2) Storage disks (Pendrive, CD)
 (3) Keyboard and mouse
 (4) None of these

25. Which of the following is the product of data processing?
 (1) Software program (2) Information
 (3) System (4) None of these
26. Which of the following is the most powerful type of the computer?
 (1) Super Conductor (2) Micro Computer
 (3) Super Computer (4) None of these
27. Which of the following is not used as secondary storage?
 (1) Semiconductor memory
 (2) Magnetic disks
 (3) Magnetic tapes
 (4) None of these
28. Which of the following is the fastest
 (1) CPU
 (2) Magnetic tapes and disks
 (3) Video terminal
 (4) None of these
29. In magnetic disks data is organized on the platter in a concentric sets or rings called
 (1) sector (2) track
 (3) head (4) none of these
30. A table consists of
 (1) fields and columns
 (2) rows and columns
 (3) rows and cells
 (4) none of these
31. CD-ROM stands for
 (1) Compactable Read Only Memory
 (2) Compactable Disk Read Only Memory
 (3) Compact Disk Read Only Memory
 (4) None of these
32. Which of the following is **NOT** one of the major data processing functions of a computer?
 (1) Gathering data
 (2) Processing data into information
 (3) Analyzing the data or information
 (4) None of these
33. Computers gather data, which means that they allow users to _____ data.
 (1) input
 (2) output
 (3) store
 (4) none of these
34. Computers use the ___ language to process data.
 (1) processing
 (2) kilobyte
 (3) binary
 (4) none of these
35. All of the following are examples of input devices EXCEPT a:
 (1) Scanner
 (2) mouse
 (3) printer
 (4) none of these
36. _____ is a set of computer programs used on a computer to help perform tasks.
 (1) An instruction (2) Software
 (3) Memory (4) None of these
37. _____ are specially designed computers that perform complex calculations extremely rapidly.
 (1) Servers (2) Laptops
 (3) Supercomputers (4) None of these
38. Which of the following is the correct order of the four major functions of a computer?
 (1) Process → Output → Input → Storage
 (2) Input → Output → Process → Storage
 (3) Input → Process → Output → Storage
 (4) None of these
39. The metal or plastic case that holds all the physical parts of the computer is the:
 (1) System unit (2) CPU
 (3) Mainframe (4) None of these
40. ISO stands for
 (1) Integrated Services Organization
 (2) International Student Organization
 (3) International Standard Organization
 (4) None of these

INTERACTIVE SECTION

41. Which sheet is active on the workbook?

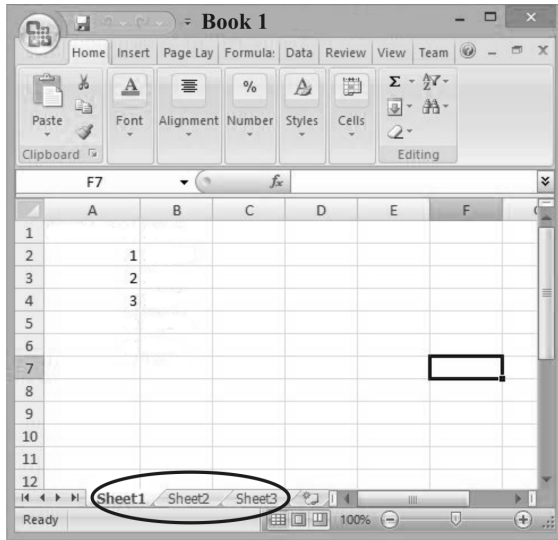

- (1) Sheet 1 (2) Sheet 2
 (3) Sheet 3 (4) None of these

42. Antivirus is used to

- (1) Delete Important files (2) Garbage collection
 (3) Removing virus (4) None of these

43. To connect to the Net you need a modem, a telephone line and a software called a _____.

- (1) Facebook (2) Power point
 (3) Web browser (4) None of these

44. **Virus** is a program written using one of the computer languages to cause damage to the Data, the information stored in the computer, or the hardware of the computer. The most common damage done by a virus is

- (1) Erase or corrupt useful data from the hard disk.
 (2) Increase the file size of command file by several 1000 bytes.
 (3) Slow down the computer

(4) None of these

45. In a supermarket, which of the following will be found in used in its computerised system?

- (1) Scanner (2) Bar coder
 (3) Both (1) and (2) (4) None of these

46. Reena has a graphic of a tree next to a house, but she only wants to use the tree. Which of the following commands in a graphics program will allow her to alter the picture the way she wants it?

- (1) Copy (2) Crop
 (3) Styles (4) None of these

47. Clipart is a collection of

- (1) Pictures (2) Fonts
 (3) Styles (4) None of these

48. Zooming of document is applicable for _____.

- (1) 1 view (2) 2 views
 (3) all views (4) None of these

49. You get this window in

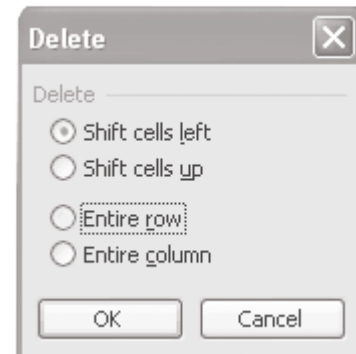

- (1) MS-Access (2) MS-word
 (3) MS-Excel (4) None of these

50. You can Undo the last action by using the short cut key,

- (1) Delete (2) Ctrl + Z
 (3) Ctrl + X (4) None of these



END OF THE EXAM